

Front Hub HB-RM40

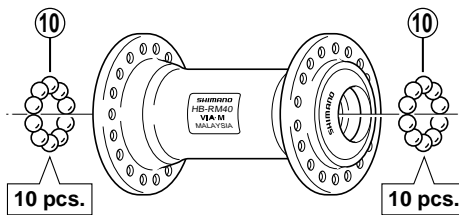
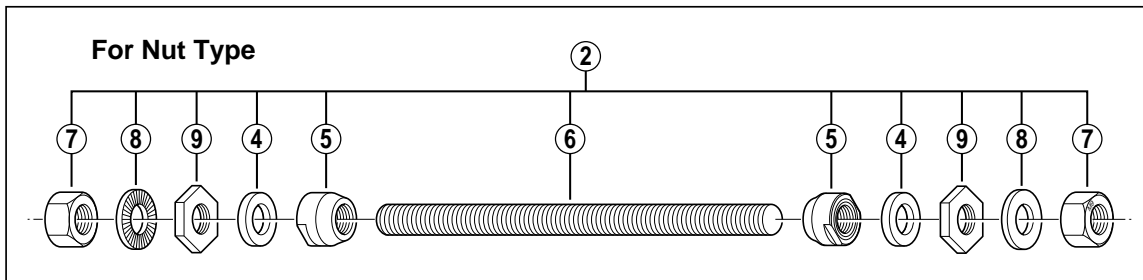
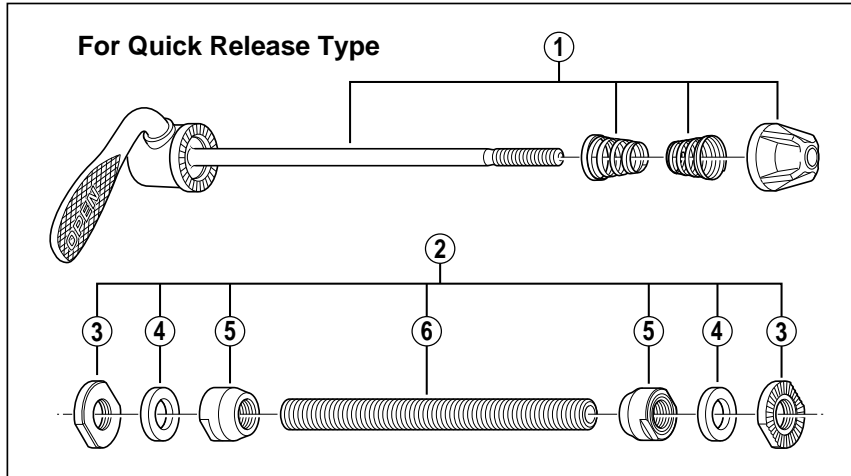

• Over Lock Nut Dimensions: Quick Release Type / Nut Type...100 mm (3-15/16")

ITEM NO.	SHIMANO CODE NO.	DESCRIPTION
1	Y-2ST 98030	Complete Quick Release 133 mm (5-1/4")
2	Y-21H 98050	Complete Hub Axle 108 mm (4-1/4") for Quick Release Type
	Y-21J 98010	Complete Hub Axle 140 mm (5-1/2") for Nut Type
3	Y-21H 08100	Serrated Lock Nut 3 mm for Quick Release Type
4	Y-301 07020	Washer 2 mm
5	Y-231 04000	Cone M9 x 10.4 mm
6	Y-21C 03100	Hub Axle 108 mm (4-1/4") for Quick Release Type
	Y-21D 05200	Hub Axle 140 mm (5-1/2") for Nut Type
7	Y-21D 02000	Fixing Nut
8	Y-21D 03000	Roller Washer 2 mm
9	Y-21D 04010	Lock Nut 3 mm for Nut Type
10	Y-000 91210	Steel Ball (3/16") 20 pcs.

0806-1588B